

Solenoid Valves for Steam & Bath Applications

GC Valves offers a wide range of solenoid valves and manifolds for the steam, bath, spa, and custom plumbing markets. Whether you need a valve with durable seals for steam shower applications, angle-bodied valves to fill a water reservoir, or manifolds to consolidate complicated plumbing, GC Valves can help.

Valve Design Features

- Body materials include brass, stainless steel, and nylon
- Pipe sizes ranging from 1/8" to 2" NPT
- Pressure ratings up to 2400 PSI for water/air and 150 PSI for steam
- NSF/ANSI/CAN 61 options available
- UL, CSA, and CE approved coil options
- Seal materials include Rulon, PTFE, EPDM, FKM, Nitrile, and other elastomers
- Conduit, DIN, and Junction Box housing options
- Zero pressure differential valves available for drain applications



Manifold Design Features

- Pipe sizes include 1/8" to 3/4" NPT
- Reduces the number of plumbing connections, simplifies installation
- Standard body material: Brass, Stainless Steel
- Optional materials: Aluminum, PVC, other thermoplastics, plating available
- Reverse manifolds, normally open operator, and 3-way options are available



CUSTOM SOLUTIONS



We produce over 1.5 million solenoid valves annually. GC Valves has a history of tailoring solutions for OEMs with demanding applications. Whether you need to design around temperature, pressure, chemical compatibility, flow, or reliability, GC Valves can provide a fluid control solution to meet your needs.

Our world-class engineering team and product portfolio allow for custom solutions in a wide variety of applications. The valves shown here are a small portion of our offering and just a hint of what we can provide with regards to custom valves. Our long history of collaborating with OEMs gives us the experience and comfort level needed to solve difficult design challenges. We pride ourselves on making cost-effective custom solutions, understanding the demands of manufacturers, and providing our products on time, tested, and of the highest quality.

ENGINEERING CAPABILITIES

3D Modeling and 3D Printing - Rapid Prototypes

- STEP files
- Solidworks part
- ACIS
- Pro/E and Creo part
- Parasolid files
- IGES files and more!
- Quick delivery time
- Multiple materials
- Fitment check
- Low-pressure fluid testing
- Tangible design

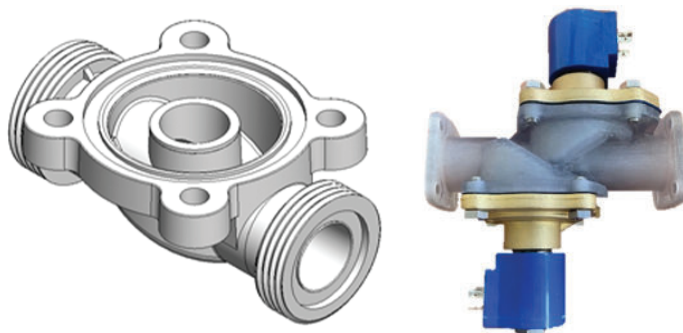

Sales Drawings

- Basic views
- Overall dimensions
- Specifications

Test Reports

- Professional reports
- Certified results
- Data-driven decisions

Testing Capabilities

- Burst testing
- Noise
- Flow
- Torque
- Water hammer
- Life cycle
- Heat Rise and
- Hi-Pot (High Potential)
- Maximum operating pressure differential
- Minimum opening pressure
- Chemical compatibility
- Internal and External leakage



GC Valves, LLC

456 Crompton Street
Charlotte, NC 28273

Tel: 800-828-0484

 gcvales.com

 sales@GCValves.com